

# Application technique of double donning sterile cleanroom gloves

## Double gloving

Open package – 1st pair

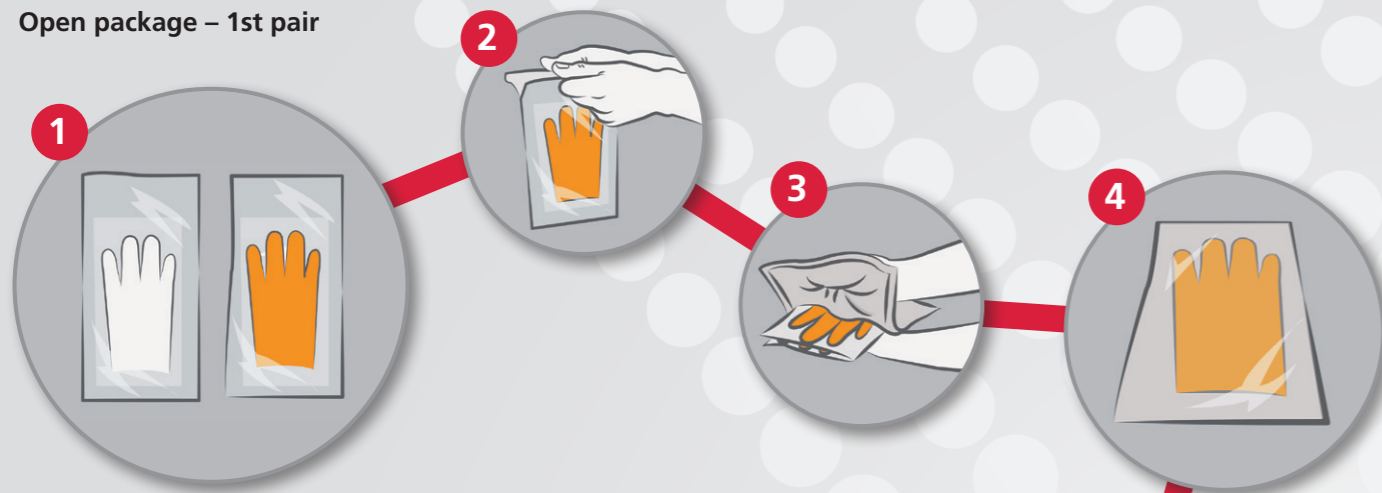

Contamination-free dressing – 1st pair



Choose for the inner gloves a lurid coloured pair and for the outer gloves a natural-coloured one to identify as soon as possible a leakage and to change accordingly the gloves.

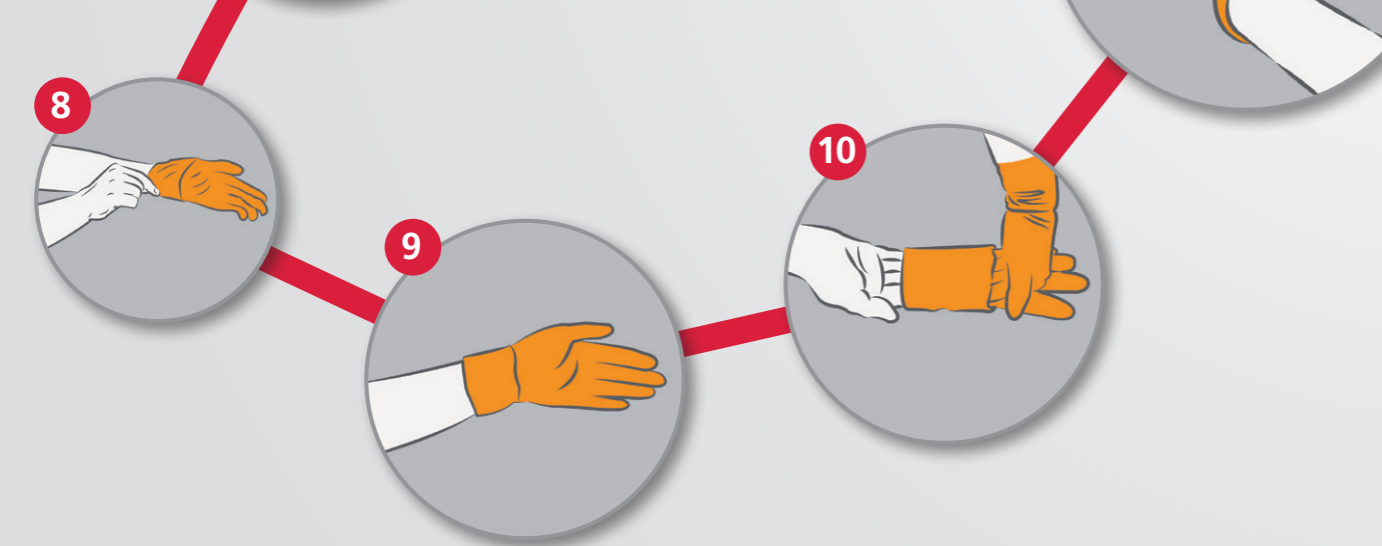

Contamination-free dressing – 2nd pair

